

Xinger®

Balun Transformers

Description

The 3A412 is a low profile balanced to unbalanced transformer in an easy to use surface mount package covering GSM, D-AMPS, IDEN and NMT900 push-pull amplifier and mixer applications. The 3A412 has an unbalanced port impedance of 50Ω and balanced port impedance of 12.5Ω to ground with 25Ω balance between outputs. This eases the matching of the push-pull amplifier's power transistors which have low impedance levels. The output ports have equal amplitude (-3dB) with 180° phase differential.



Features

- 800 - 1000 MHz
- 12.5Ω (to ground) Balanced Port Impedance
- Low Insertion Loss
- High Power
- Input to Output DC Isolation
- Surface Mountable
- Tape And Reel
- Convenient Package

Electrical Specifications

Frequency MHz	Port Impedance Unbalanced	Port Impedance Balanced to Ground
800 - 1000	50Ω	12.5 + j1.0Ω
Return Loss dB Min	Amplitude Bal. dB (p-p)	Phase Balance degrees
15	0.40	180 ± 5.0
Insertion Loss dB Max	Θ _{JC} °C/diss. Watt	Power Watts Ave/CW
0.35	3.8	250

Specifications subject to change without notice.

Outline Drawing

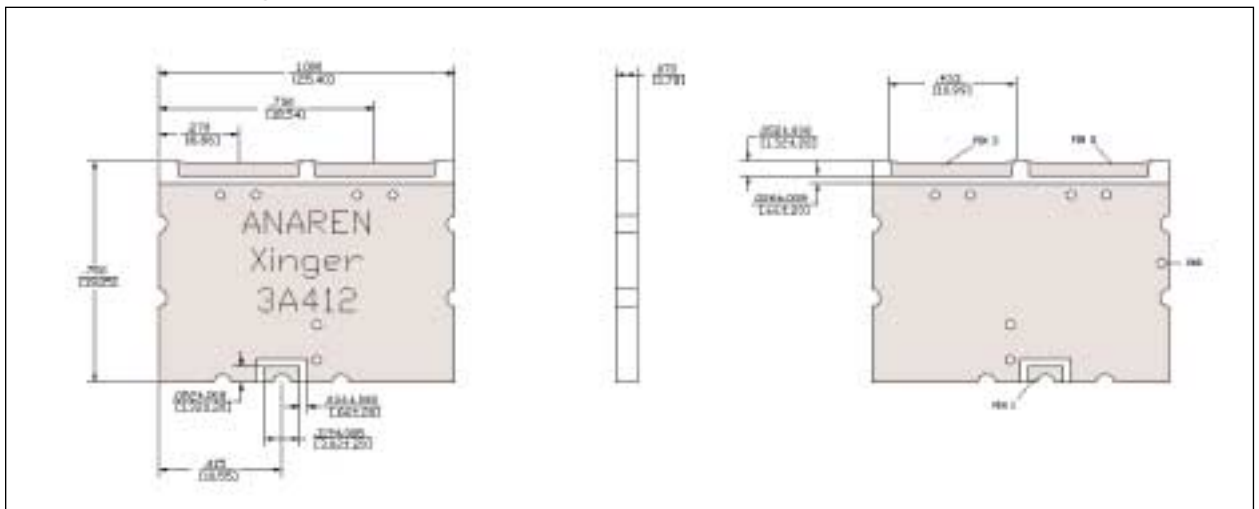

Available on Tape and Reel for Pick and Place Manufacturing.

Sales Desk USA: Voice: (800) 544-2414 Fax: (315) 432-9121
 Sales Desk Europe: Voice: (+44) 23 92 232392 Fax: (+44) 23 92 251369

